



MAKERS OF RESPIRATORY VALVES SINCE 1938

HANS RUDOLPH, inc.

www.rudolphkc.com

TEL: (913) 422-7788

U.S.A. & CANADA: (800) 456-6695

FAX: (913) 422-3337

E-Mail: hri@rudolphkc.com

8325 COLE PARKWAY, SHAWNEE, KANSAS 66227 U.S.A.

Data Sheet...

CPAPMAN.COM
BEST SERVICE SINCE 1997
Click Here To Order Today

7600 Series V2 Mask™
ORO-NASAL CPAP/BiLevel with AAV & Vents
REUSABLE

Large, Medium, Small, Extra Small, Petite

PRODUCT FEATURES

- **Five Sizes** to cover a wide range of patient sizes.
- **Face Piece with new Facial Sealing Flange** is a single piece mask, made of clear soft Silicone Rubber.
- **Anatomically Contoured Face Mask Design with ribbed support** for a leak free comfortable fit.
- **Anti-Asphyxia Valve (AAV)** for patient safety - allows patient to breathe room air if the flow device malfunctions. Valve opens at mask pressures less than 3cm H₂O.
- **Swivel Port Micro Vent Holes** dissipate CO₂.
- **360° Dual Swivel Elbow Port with Detachable Swivel Port** for improved patient freedom of movement. Color coded translucent blue.
- **Easily adjustable, light weight, 4 strap Headgear** for patient comfort, available in three sizes.
- **New Quick-Release Strap Clips** for quick & simple mounting & dismounting of headgear.
- **Lightweight, easy to use, high quality mask & headgear.**
- **Reusable masks; steam autoclaveable, cold chemical, pasteurization safe & dishwasher safe.**

SPECIFICATIONS

MATERIALS (See Fig. A)	
Face Piece with Structural Braces	Silicone Rubber, Polycarbonate Thermoplastic
Swivel Port - Mask Adapter, Elbow, 22mm Port	Polycarbonate Thermoplastic, Translucent Blue
Swivel Port - AAV Port	Polycarbonate Thermoplastic Translucent
Diaphragm	Silicone Rubber
Headgear	Polyurethane Foam Black, Nylon UBL Gray and Nylon Fabric Red
Headgear Hook	Nylon, Black
Headgear Strap Clips (4), Tri-glide	Polypropylene, Black



Oro-Nasal CPAP/BiLevel V2 Mask™ with Headgear

GENERAL INFORMATION

- **Intended Use:** The Hans Rudolph 7600 V2 Mask™ series are reusable, multi-patient use, adult Oro-Nasal CPAP/BiLevel mask which incorporates passive, continuous flow exhaust port built into the mask. It is intended for use with CPAP/BiLevel machines for treatment of obstructive sleep apnea, and for use with other similar ventilators that use this exhaust port configuration providing a minimum of 3 cmH₂O pressure measured at the mask.
- **Indications for Use:** The V2 Mask™ are for use on adult patients (greater than 30 kilograms weight) for treatment of Obstructive Sleep Apnea or any other conditions requiring CPAP/BiLevel or non-invasive ventilatory support at pressures greater than or equal to 3.0 cmH₂O at the mask in homes, hospitals and other clinical settings.
- **Environment of Use:** The V2 Masks™ are for use in homes, hospitals and other clinical settings by individuals that have at least minimal instructions or training on the use of the mask as well as the device to which the mask are intended to connect.
- **Cautions:**
 - a.) Federal law restricts this device to sale by or on the order of a physician.
 - b.) At low BiLevel pressures the flow through the patient circuit vent holes may be inadequate to clear all exhaled gas from the tubing. Some rebreathing may occur.
 - c.) Patients with facial hair, especially beards, may experience mask leakage which may require shaving the hair.
- **Warnings:** Refer to: Instructions for Use, Document No. 691270, shipped with product.
- **Contraindications & Complications:** Refer to: Instructions for Use, Document No. 691270, shipped with product.

PHYSICAL CHARACTERISTICS

Face Mask Dimensions

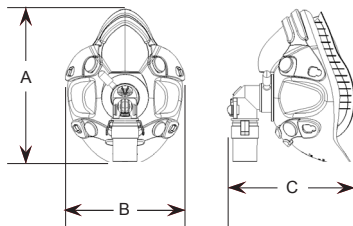

Mask Deadspace Volume (ml) With 22mm ID Elbow Swivel Port				
Large 170	Medium 152	Small 126	Extra Small 115	Petite 105

MASK SIZE WITH OVERALL DIMENSIONS - inches (mm)					
	LARGE	MEDIUM	SMALL	EXTRA SMALL	PETITE
A	5.9 (150)	5.5 (140)	5.2 (132)	4.8 (122)	4.6 (117)
B	4.2 (107)	4.16 (105)	4.05 (103)	3.95 (100)	3.9 (99)
C	4.7 (119)	4.46 (113)	4.32 (110)	4.2 (107)	4.04 (103)

7600 V2 Mask™ COMPONENTS FIG. A

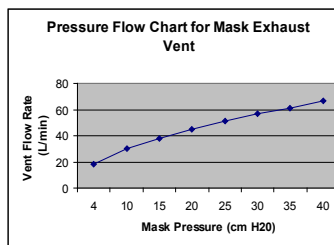
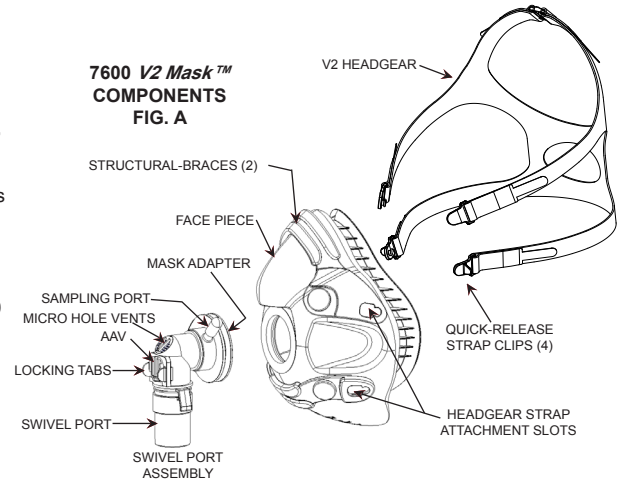

MASK SIZING GAUGE

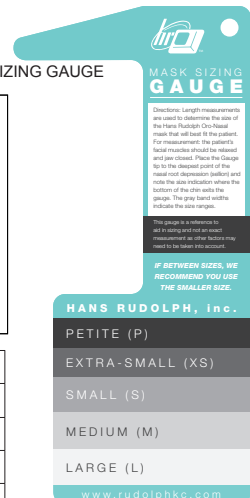

ORDERING INFORMATION - 7600 Series Reusable V2 Oro-Nasal Mask with Elbow Swivel Port 22mm OD Vented with Anti-Asphyxia Valve (AAV) & Headgear (HG)

P/N Description

	Mask, AAV Valve, Vented 22mm OD Elbow with HG
113485	7600 Large
113486	7600 Medium
113487	7600 Small
113488	7600 Extra Small
113489	7600 Petite

	Replacement Parts
669180	Face Piece Large
669181	Face Piece Medium
669182	Face Piece Small
669183	Face Piece Extra Small
669184	Face Piece Petite
201494	Headgear Large (Use with Large Mask)
201493	Headgear Medium (Use with Medium and Small Mask)
201492	Headgear Small (Use with XSmall and Petite Mask)
201523	Swivel Port, AAV, Non-Vented, 22mm OD
201555	HG Strap Clips package of four & Tri-glide
201521	AAV Port assembly
211022	Cap Plugs for sampling port package of two

	Accessories
691143	Mask Sizing Gauge for V2 Oro-Nasal Masks
669353	METRO™ NG Tube Seal Disposable Package of 1